

MULTICOM™ WALL-PANELLING SYSTEM

Resco NZ Ltd specialises in the design and manufacturing of Compact Laminate propriety restroom systems.
Compact laminate resin components are "fit for their purpose" by design.

SPECIFICATIONS:

- 6 mm MULTICOM™ Pre-finished Compact laminate panels.

FEATURES:

- Large 2440 x 1840 sheet-size, minimises number of jointers.
- Suitable for both toilet and shower situations, as compact laminate panels are impervious to water.
- High impact resistance makes it the panel of choice for changing rooms and public area's.
- Blind fixing by means of double sided tape and MS-polymer adhesive, aluminium P/C jointers and corner profiles.
- Graffiti resistant
- Not susceptible to mould, rot or fungi and bacteria.
- Suitable for food-preparation areas.
- Fire behaviour; CLASS 2; Fire retardant and no toxic fumes.

BENEFITS:

- Compact panel technology guarantees an extended product-life. **(10 yr. guarantee on panel-integrity)**
- Cost-effective high-impact resistant **one panel** system, with no need for conventional impact resistant backing sheets.
- The **large sheet-size** allows for economic configuration options.
- Powder-coated **aluminium jointers** and profiles, complement the aesthetically pleasing finish.

COLOUR RANGE

- M01597 - **White**
- M01835 - **Off-white**
- M20102 - **Silver-grey Speckled**

PANEL CONFIGURATION-OPTIONS

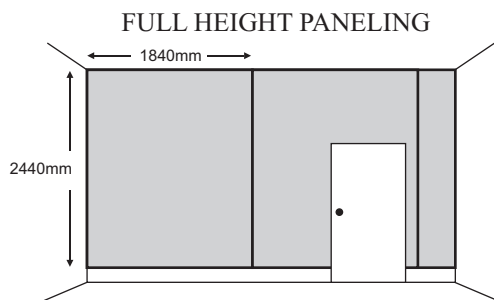

The 2440mm sheet-size allows panels to go to full 2400 mm room-height and jointers at intervals of 1840 mm along the room.

DEMARICATION-LINE @ 2mtr.(door) HEIGHT

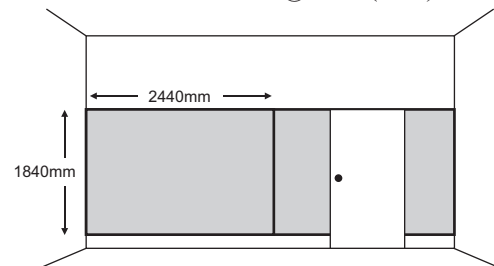

The 1840 mm sheet-size allows panels to go to a 2 mtr. high demarcation-line, (often door-height), with 160 mm of coving between floor and wall-panels.

This allows jointers at intervals of 2440 mm, halving the number of jointers compared to most wall-panelling systems.

PANEL FIXING-OPTIONS

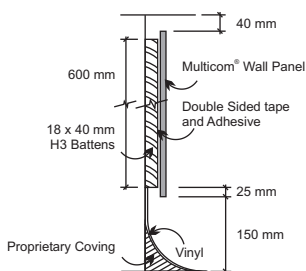

CROSS SECTION OF BLOCK WALL

LOCATION: BLOCK WALLS, GIB or OTHER FLAT SHEETS & TIMBER FRAMED WALLS IN WET AREA'S

Panels to be fixed to 18mm vertical battens, strapped at 600mm intervals.

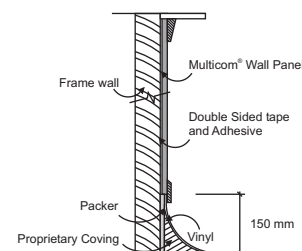

CROSS SECTION OF TIMBER FRAMED WALL

LOCATION: TIMBER FRAMED WALLS IN DRY AREA'S

Panels can be fixed straight to the timber framing.

ALUMINIUM JOINTERS:

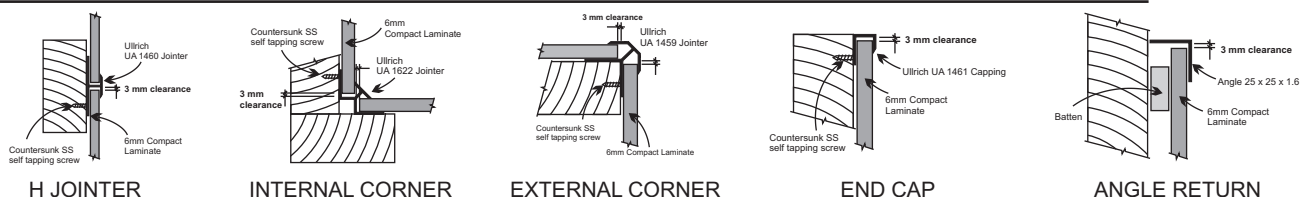

PANEL MACHINING

- **Skill-saw:** The panels can be cut with a skill-saw, using a fine-tooth tungsten tipped blade.
- **Router:** Routers or tungsten tipped hole-saws can be used for cutting holes.
- **Sandpaper:** No 400 sandpaper may be useful to erase edges.
- **Screwdriver:** A cordless screwdriver / drill may be needed to screw fix the aluminium jointers to the frame or battens. Where battens are to be strapped to concrete or blocks, a masonry drill-bit, screws and plugs may be required.